

# 3-Channel Professional Colour NAVTEX



**Sirius-3** is a 3-channel NAVTEX receiver for SOLAS vessels which comply with the new NAVTEX performance standard. The **Sirius-3** can simultaneously receive three channels.

## Features:

- Large colour touchscreen 6.2" with daylight and night mode
- 3 parallel operating receivers for all IMO Navtex frequencies
- 1,000 messages memory with quick select
- 12/24V DC supply
- Low power consumption
- NMEA interface
- Compatible with Thrane Link
- Printer interface
- Wheel marked
- Waterproof from front
- Interface for central muting of alarms
- USB Interface
- Green Passport

## Options:

- Active 3 frequency antenna NA-3
- Flush Mounting Kit
- Tabletop or bulkhead mounting bracket
- USB Printer

## Approvals:

- Wheel Mark, FCC (US) and IC (Canada)

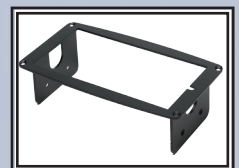

## Polaris Electronics A/S

Kærholt 1 • P.O. Box 7957 • DK-9210 Aalborg SØ

Tel.: +45 9631 7900 • Fax: +45 9631 7901

E-mail: info@polaris-as.dk • Web: www.polaris-as.dk

# DIMENSIONS

202 mm

68 mm

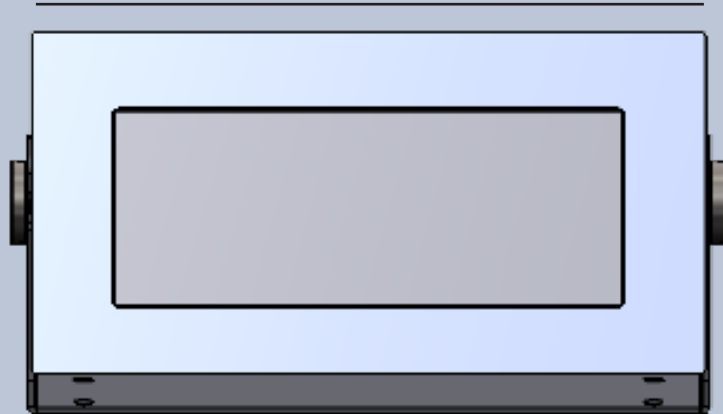

Built-in dimension: 100 x 200 mm

102 mm

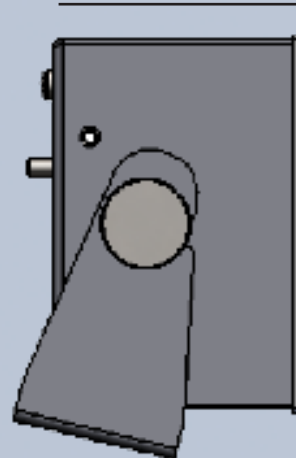

## SPECIFICATIONS

<b>Receiving mode</b>	F1B NAVTEX Broadcast
<b>Receiving frequencies</b>	490, 518 & 4209.5 kHz
<b>Frequency Stability</b>	+/- 10Hz
<b>Display</b>	6.2" Colour Touchscreen
<b>Menu languages support</b>	English
<b>Received messages</b>	Each Channels: 1,000 Messages
<b>Data Backup</b>	72 Hours
<b>Rear Connections</b>	Antenna PL259, 50 ohm (12V DC to Active Antenna) Power, Alarm, Mute RS422 NMEA 0183 Input- /Output USB: Printer, Software Update Earth Connection
<b>Power supply</b>	12/24V DC Nominal (10 to 29V DC, 4,8W)
<b>Operating Temperature Range</b>	-15 C to +55 C
<b>Storage Temperature Range</b>	-20 C to +55 C
<b>Humidity</b>	0 to 95%, non-condensing

## CONFIGURATIONS

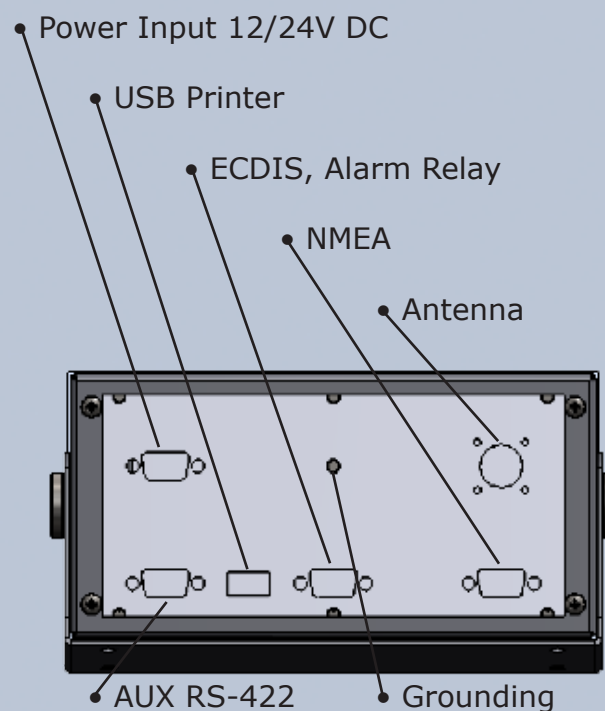

**For further information, contact:**