

### HF8000 TX/RX

#### 8 m three-part LF/HF Fibreglass Antenna

- High quality 8 m high HF antenna for professional use
- Designed for GMDSS installations
- Rugged design
- Chrome plated solid brass joints
- Designed for rail mounting
- Side fed via open single wire
- Full omni-directional radiation pattern

#### Electrical Specifications:

Frequency	1.4 - 30 MHz (MF and HF)
Polarisation	Vertical
Max. Input Power	1200 W PEP
Static Capacitance	100 pF
Insulation Resistance	10 GOhm
Electric Length	6790 mm

#### Mechanical Specifications:

Color	White
Height	8 m
Weight	6.0 kg
Diameter	Ø 40 to Ø 5 mm
Mounting	Rail Bracket Kit (Large) P/N 10000-163 (Not supplied!)
Mounting place	On rail or pole (Ø 30 - 90 mm)
Mounting instruction	Supplied
Materials	PU-painted heavy duty glass-fibre tubes and chromed solid brass
Survival Wind Speed	55 m/s (125 mph)
Operating temperature	-55C to +70C (IEC 60068-2-1, IEC 60068-2-2)
Connector	Screw terminal
Cable	No cable supplied (Use open single wire)
Serial no.	On product label

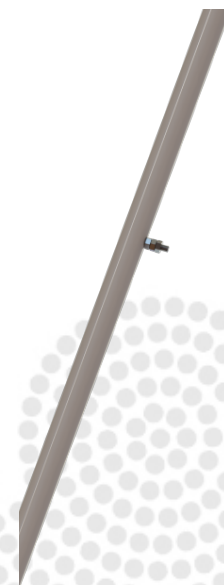

Ordering information:

P/N	13800-002 (Without brackets)
-----	------------------------------

Packaging Information:

Type	Carton tube
Size	Ø 86 x 2900 mm
Weight	Approx. 9.0 kg

Outline Drawing

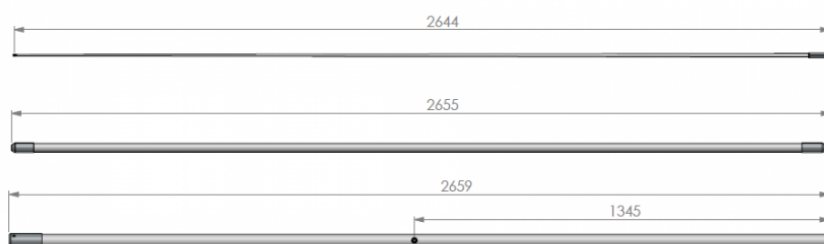

Mounting

